

Wire Wound Chip Ferrite Inductor ACW/ADW Series

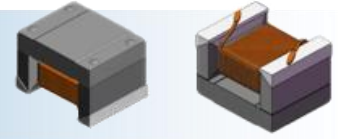

Operating Temp. : -40°C~+125°C

FEATURES:

- ⊙ Broadband impedance characteristics .
- ⊙ Good DC superimposition characteristics.
- ⊙ Efficient transmission signal .
- ⊙ The range of filter video noise from MHz to GHz.
- ⊙ High saturation current, low DCR .
- ⊙ AEC-Q200 verified.

APPLICATIONS:

- ⊙ PoC line for automotive camera system.

ACW 3225 2R2 M

① ② ③ ④

PART NUMBERING SYSTEM:

- ①: Automobile Type
- ②: External Dimensions (L*W:3.2*2.5mm)
- ③: Inductance Value (2R2 = 2.2uH)
- ④: Tolerance(M: ±20%)

SHAPES AND DIMENSIONS: (Unit:mm)

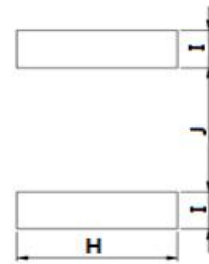
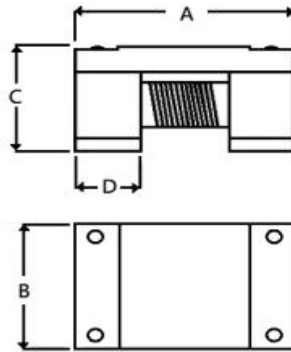

Recommended Land Pattern

SERIES	A	B	C	D	H	I	J
ADW/ACW2012	2.0±0.2	1.27±0.2	1.6±0.2	0.54 Ref	1.5 Ref	1.1 Ref	1.0 Ref
ACW3225	3.2±0.2	2.5±0.2	2.3±0.2	0.55 Ref	2.7 Ref	0.9 Ref	2.0 Ref
ACW4532	4.5±0.2	3.2±0.2	3.5±0.2	0.8 Ref	3.25 Ref	0.95 Ref	3.0 Ref

ACW2012 Series

SPECIFICATION TABLE:

Part No.	Inductance (uH)	Test Condition	DCR (Ω) Max	Saturation Current (mA)	Irms Max (mA)	Self-resonant Frequency (MHZ) Min
ACW2012-R47M	0.47±20%	1MHz,1V	0.05	1000	1100	470
ACW2012-R82M	0.82±20%	1MHz,1V	0.09	800	800	360
ACW2012-1R0M	1.0±20%	1MHz,1V	0.13	700	700	320
ACW2012-1R5M	1.5±20%	1MHz,1V	0.18	550	550	260
ACW2012-2R0M	2.0±20%	1MHz,1V	0.29	450	450	230

ADW2012 Series

SPECIFICATION TABLE:

Part No.	Inductance (uH)	Test Condition	DCR (Ω) Max	Saturation Current (mA)	Irms Max (mA)	Self-resonant Frequency (MHZ) Min
ADW2012-2R2M	2.2±20%	1MHz,1V	0.50	900	400	360

- ⊙ Operating temperature range : -40℃~125℃(Including self - temperature rise)
- ⊙ Storage temperature range (packaging conditions): -40℃~125℃(Including self - temperature rise)
- ⊙ Rated current: Isat(Max) or Irms(Max), whichever is smaller.
- ⊙ Irms: DC current that causes the temperature rise (ΔT) from 20℃ ambient; For Max. Value, temperature rise (ΔT) is 20℃. For Typ. Value, temperature rise (ΔT) is approximate 40℃.

Impedance Vs Frequency Curve

TYPICAL ELECTRICAL CHARACTERISTICS:

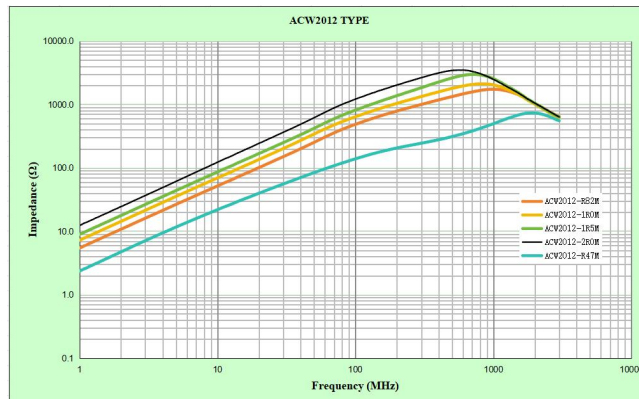

ACW2012 Series

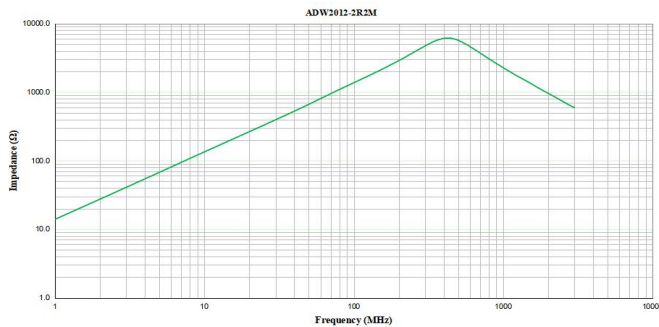

ADW2012-2R2M

ACW3225 Series

SPECIFICATION TABLE:

Part No.	Inductance (uH)	Test Condition	DCR (Ω) Max	Saturation Current (mA)	Irms Max (mA)	Self-resonant Frequency (MHZ) Min
ACW3225-2R2M	2.2±20%	1MHz,1V	0.19	1000	1000	200
ACW3225-2R7M	2.7±20%	1MHz,1V	0.22	975	975	200
ACW3225-3R3M	3.3±20%	1MHz,1V	0.24	950	950	150
ACW3225-4R7M	4.7±20%	1MHz,1V	0.28	850	850	100
ACW3225-6R8M	6.8±20%	1MHz,1V	0.32	750	750	100
ACW3225-100M	10±20%	1MHz,1V	0.40	500	700	100
ACW3225-220M	22±20%	1MHz,1V	0.62	400	550	50
ACW3225-470M	47±20%	1MHz,1V	0.90	300	500	30

- ⊙ Operating temperature range : -40℃~125℃ (Including self - temperature rise)
- ⊙ Storage temperature range (packaging conditions): -40℃~125℃ (Including self - temperature rise)
- ⊙ Rated current: Isat(Max) or Irms(Max), whichever is smaller.
- ⊙ Irms: DC current that causes the temperature rise (ΔT) from 20℃ ambient; For Max. Value, temperature rise (ΔT) is 20℃. For Typ. Value, temperature rise (ΔT) is approximate 40℃.

Impedance Vs Frequency Curve

TYPICAL ELECTRICAL CHARACTERISTICS:

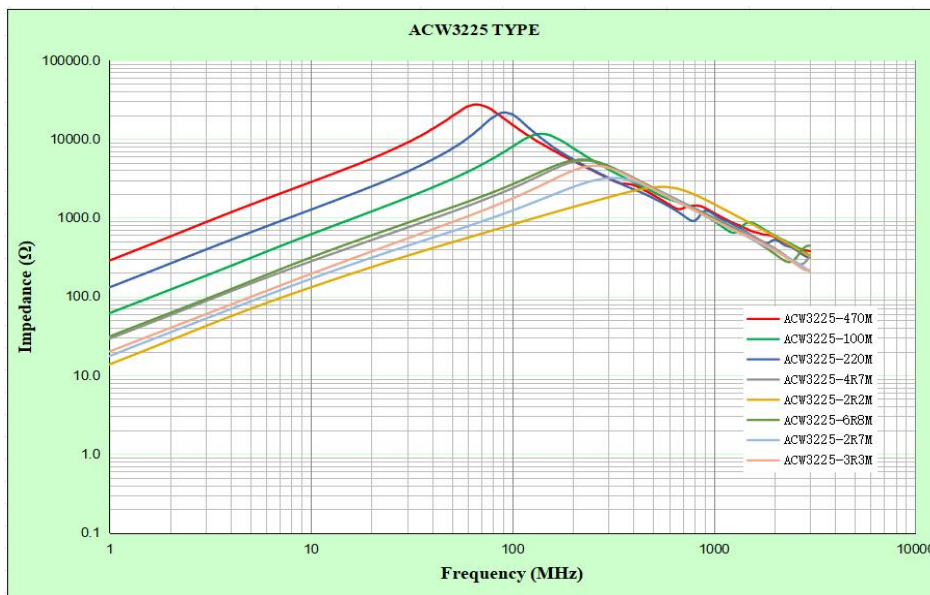

ACW3225 Series

ACW4532 Series

SPECIFICATION TABLE:

Part No.	Inductance (uH)	Test Condition	DCR (Ω) Max	Saturation Current (mA)	Irms Max (mA)	Self-resonant Frequency (MHZ) Min
ACW4532-100M	10±20%	1MHz,1V	0.13	1000	710	60
ACW4532-180M	18±20%	1MHz,1V	0.16	800	840	40

- ⊙ Operating temperature range : -40°C ~ 125°C (Including self - temperature rise)
- ⊙ Storage temperature range (packaging conditions): -40°C ~ 125°C (Including self - temperature rise)
- ⊙ Rated current: Isat(Max) or Irms(Max), whichever is smaller.
- ⊙ Irms: DC current that causes the temperature rise (ΔT) from 20°C ambient; For Max. Value, temperature rise (ΔT) is 20°C. For Typ. Value, temperature rise (ΔT) is approximate 40°C.

Impedance Vs Frequency Curve

TYPICAL ELECTRICAL CHARACTERISTICS:

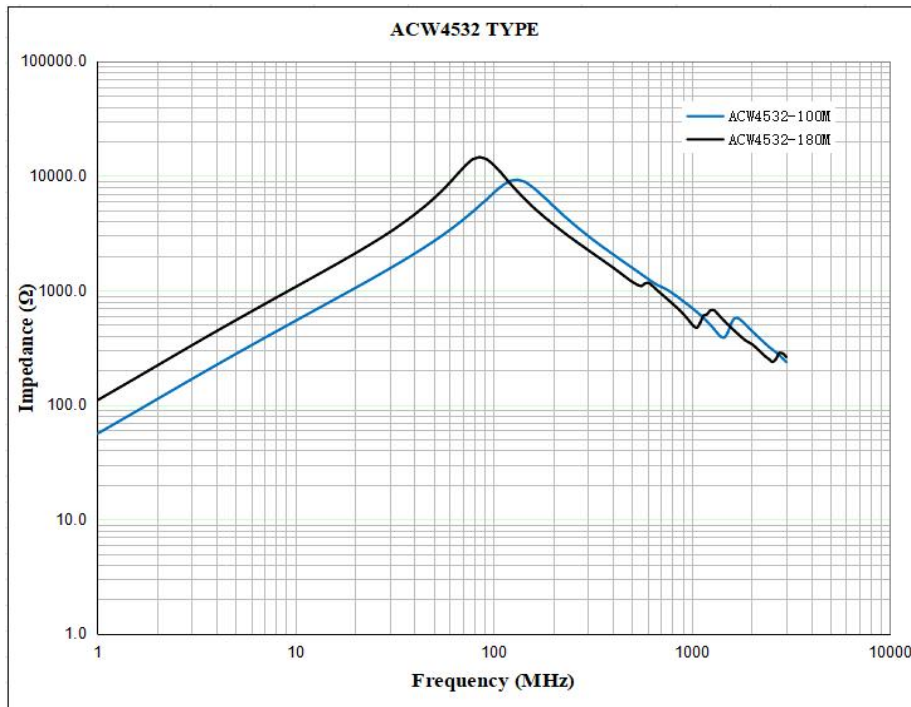

ACW4532 Series